

The Corner Shops at Chesterfield Towne Center

At the North East Corner of Midlothian Turnpike and Huguenot Road
11530 Midlothian Turnpike | Richmond, VA 23235



NOW AVAILABLE: Space 890 sq ft



- High profile, street front space 1B: 890 sq ft 25' wide by 46' deep, new glass storefront with double doors
- Available 2022
- Join Sleep Number, Complete Dental and Xfinity
- 100,000 VPD of traffic at a stoplight intersection in front of site
- Signage on two sides of building and 1/3 panel on pylon sign
- The Chesterfield Towne Center which is a 900,000 sq. ft. mall that is 88% leased and is anchored by JC Penney, Macy's, H&M, Barnes & Noble, Ulta Cosmetics, Old Navy, TJ Maxx, Kirkland's, Home Goods and At Home. It is the #2 Regional Shopping Mall in the Richmond, VA area
- Costco is located just north of the mall and is their largest Richmond store which is 148,000 sq. ft. It is the highest volume wholesale store in Central VA.
- The surrounding retailers within 1 miles include, Fresh Market, DSW, Bed Bath Beyond, Michael's, Best Buy, Lowe's, Home Depot, PetsSmart, Staples, Wegmans, Lazboy, Petco, Party City, Sam's Club and Walmart. Lidl & Aldi supermarkets on Mall Drive.
- The center is located at the crossroads of Chesterfield County, which has the highest traffic count interchange in south Richmond. The traffic counts are 52,000 VPD on Midlothian Tpk and 38,000 VPD Huguenot Rd

DEMOGRAPHICS

3 Miles:

Population	57,660
HH Income	\$129,363
Daytime Pop	61,809

5 Miles:

Population	125,440
HH Income	\$122,908
Daytime Pop	122,968

TRAFFIC

- 52,000 VPD Midlothian Trnpke
- 38,000 VPD Huguenot Road



Sigma National, Inc
1213 Mall Drive
Richmond, VA 23235
(804) 423-5335
www.sigmanational.com

OWNER / AGENT

Tred Spratley (804) 423-5335, x320
tredspratley@sigmanational.com

Wilson Davis (804) 423-5335, x301
wilsondavis@sigmanational.com

The Corner Shops at Chesterfield Towne Center

At the North East Corner of Midlothian Turnpike and Huguenot Road
11530 Midlothian Turnpike | Richmond, VA 23235

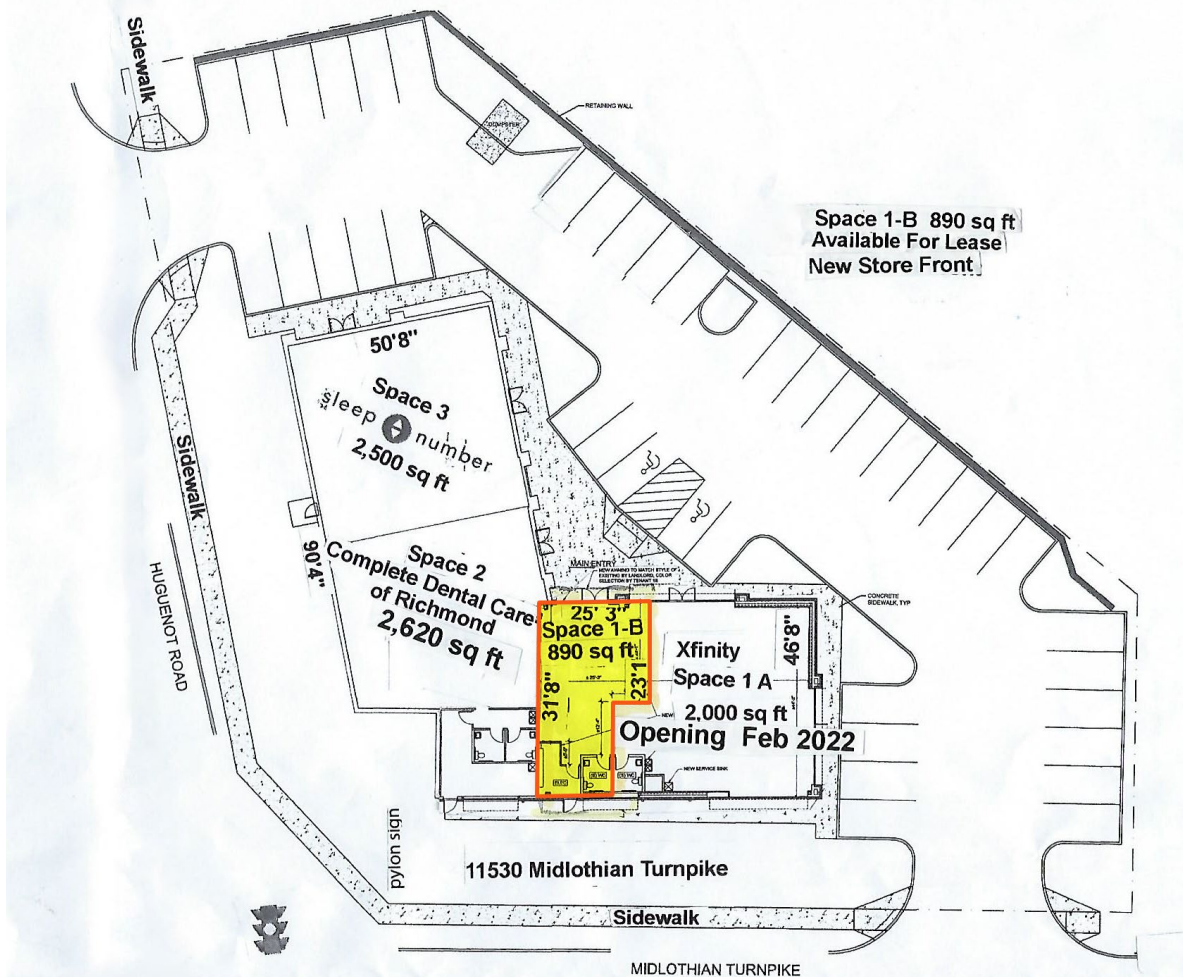

Information contained within is deemed reliable, but is not guaranteed. Subject to prior leasing.

The Corner Shops at Chesterfield Towne Center

At the North East Corner of Midlothian Turnpike and Huguenot Road
11530 Midlothian Turnpike | Richmond, VA 23235



Information contained within is deemed reliable, but is not guaranteed. Subject to prior leasing.

The Corner Shops at Chesterfield Towne Center

At the North East Corner of Midlothian Turnpike and Huguenot Road
 11530 Midlothian Turnpike | Richmond, VA 23235

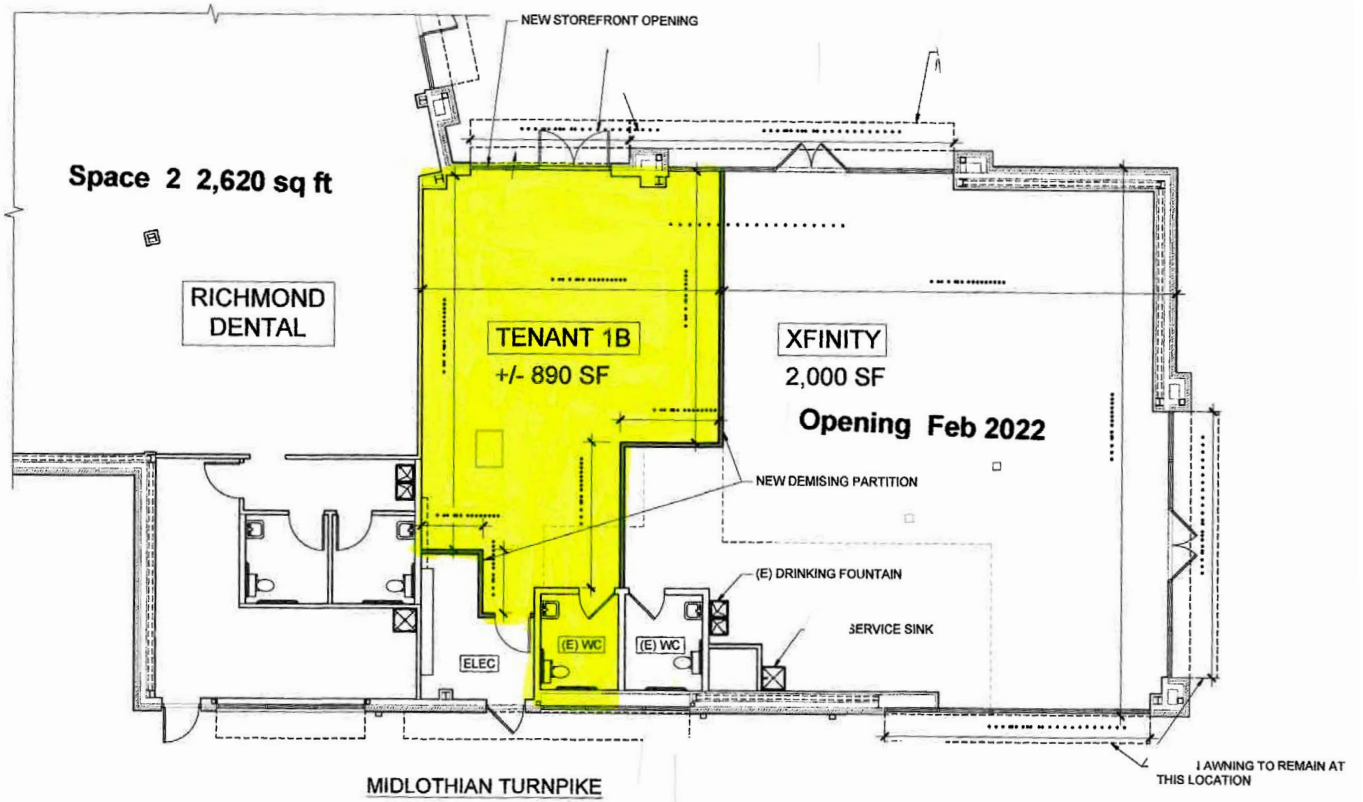

THE CORNER AT CHESTERFIELD TOWNE CENTER

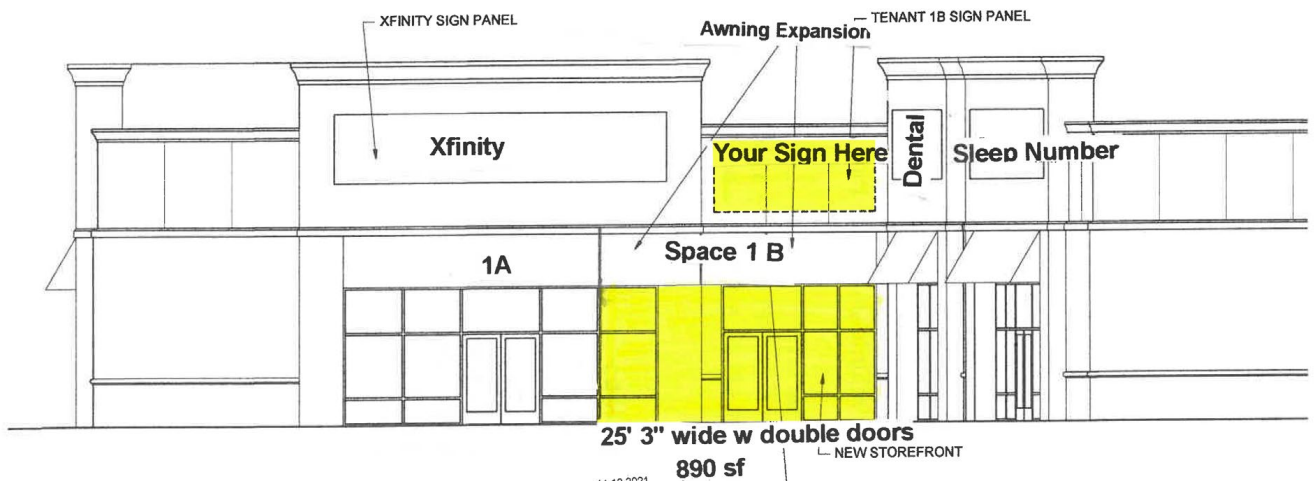

PROPOSED TENANT 1 DEMISING AND AWNING SCHEDULE

11.12.2021

1/8" = 1'-0"

THE CORNER AT CHESTERFIELD TOWNE CENTER

SECTION TO ALIGN ANGLE WITH ADJACENT AWNING

This document is for use by SIG Architects LLC only. Reproduction of this document, in whole or in part, or the modification of any detail or description of the proposed design without the express written consent of SIG Architects LLC is prohibited. All rights reserved. ©2021